

# Forked Clamp Arm

Version for V... .1 series

EF A 4...

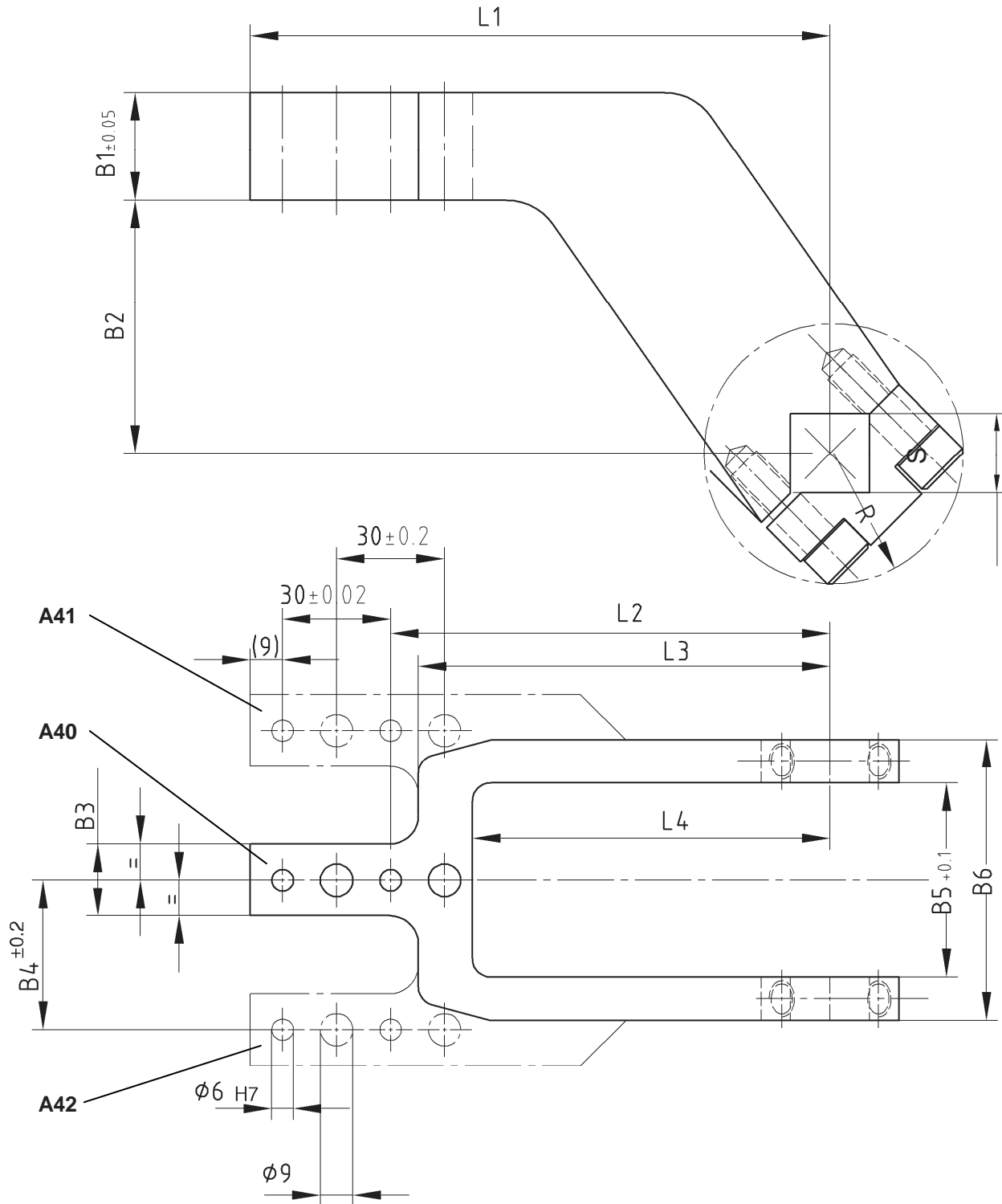

Tolerance for dowel holes  $\pm 0.02$ , for threaded holes  $\pm 0.1$ .

Type	Clamp arm version A40 Order No.	Clamp arm version A41 Order No.	Clamp arm version A42 Order No.	$B1$ $\pm 0.05$	$B2$	$B3$	$B4$ $\pm 0.1$	$B5$	$B6$	$L1$	$L2$ $\pm 0.05$	$L3$	$L4$ $\pm 0.1$	$S$ $h9$
V/V2 50.1	242838	245811	245812	28	45	20	34	48	68	144	105	95	80	19
V/V2 63.1	242839	245848	245849	28		20	37	54	78	144	105	95	80	22
V/V2 80.1	246238	248921	248923	35		25	50.5	76	108	179	140	135	115	30