

# Underbody Clamp

With locating pin and swivel hook for locating Ø30-40

# FK 50 UZ

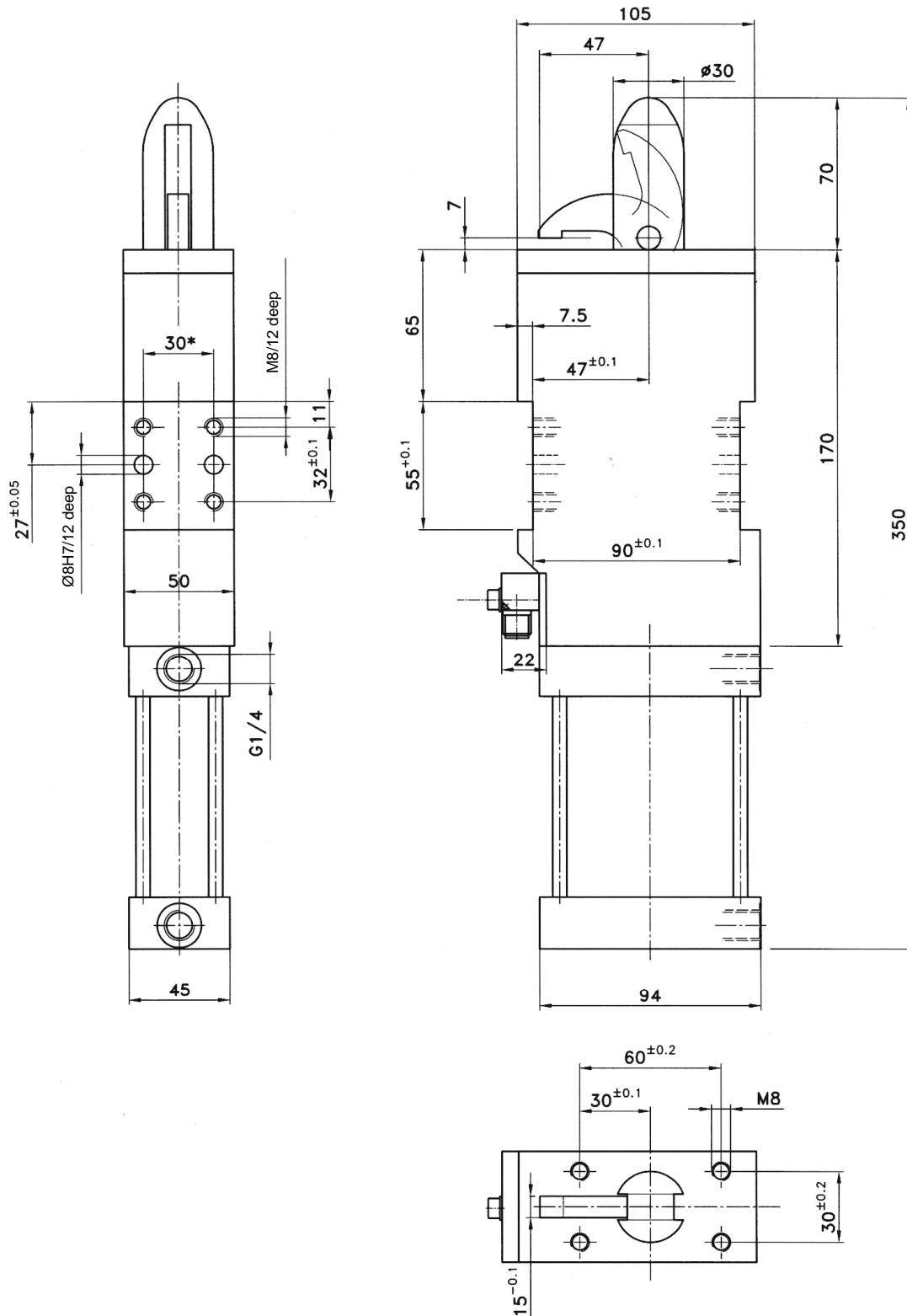

### Ordering example:

FK 50 UZ T12

FK 50 UZ: Type  
T12: Sensing system

### Ordering example Tünkens sensing system:

...T12 Inductive sensor 24 V, 1 output with integrated LED's

### Technical data:

\*\*Holding force: 2000 N  
\*\*Clamping force: 1500 N  
Medium: Air, 6 bar  
Weight: 3,5 kg

Maximum load (\*\*) depends on diameter of dowel pin and geometry of the hook.

\*Tolerance for dowel holes  $\pm 0.02$ , for threaded holes  $\pm 0.1$ .

Medium: Air, max. 6 bar, operation permitted with oil-free air.

### Attention!

External throttle check valves must be provided on assembly. They are not included in the scope of delivery!

