

Multi Power Cylinder

with integrated power unit, flat design, anti-rotating

MZ 40 BR2

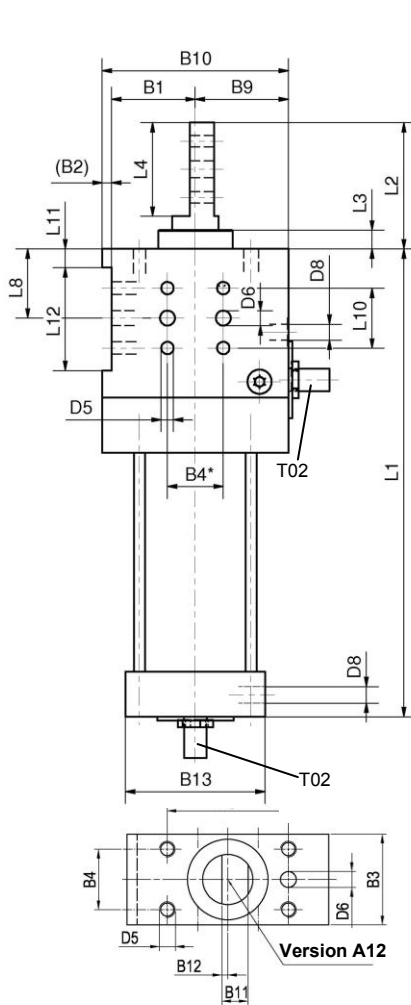

Version B: with tapped hole

Version G: with threaded hole
piston rods versions
also according to customer requirements

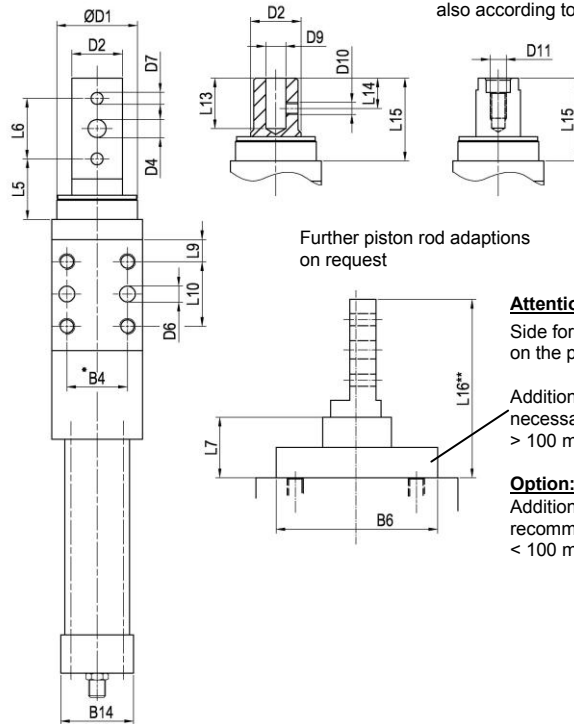

Further piston rod adaptations
on request

Attention!

Side forces may not operate
on the piston rod.

Additional guide "F" is
necessary for strokes
> 100 mm.

Option:

Additional guide "F" is
recommended for strokes
< 100 mm.

Versions „A..“

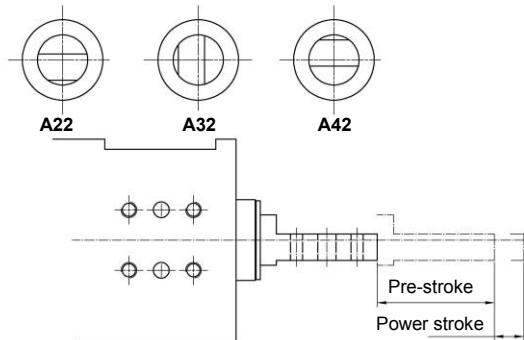

Ordering example:

MZ F 40 BR2 V 120 A12 T02

MZ BR2: Type
F: With additional guide
40: Piston Ø
V: **Optional:** with lock
120: Stroke
A12: Version
T02: Sensing system

Pre-stroke: mind. 15 mm

Standard pre-strokes:

50, 100, 150 mm (power stroke of 6 mm not included)

Further special strokes up to a maximum of 300 mm on request.

*Tolerance for dowel holes ± 0.02, for threaded holes ± 0.1.

** Dimension depends on the piston rod version (see table).

Medium: Air, max. 6 bar; operation permitted with oil-free air.

Type	Clamping force of power stroke at 6 bar	Power stroke (mm)	Cylinder force of the pre-stroke at 6 bar	Corresp. piston Ø (mm)	Weight for pre-stroke 50+6 mm approx. (kg)
MZ 40 BR2	4 kN	6	0,7 kN	40	3,0

Type	B1 ±0,02	B2	B3	B4*	B5 ±0,2	B6	B9	B10	B11	B12 ±0,05	B13	B14	D1 f7	D2 f7	D3 H7	D4	D5	D6 H7	D7 H7	D8	D9 H7
MZ 40 BR2	45	5	45	30	60	80	50	100	13	3	75	45	40	25	10	9	M8	8	6	G1/8	10

Type	D10	D11	L1	L2	L3	L4	L5	L6 ±0,02	L7	L8 ±0,05	L9 ±0,1	L10 ±0,1	L11	L12 +0,1	L13	L14	L15	L16** „A..“	L16** „B..“	L16** „G..“
MZ 40 BR2	M6	M8	195+stroke	70	12	50	30	30	45	37	11	32	10	55	25	15	41	115	74	74