

Shims

for Pneumatic Clamps K 40.1

AP 43.. complete

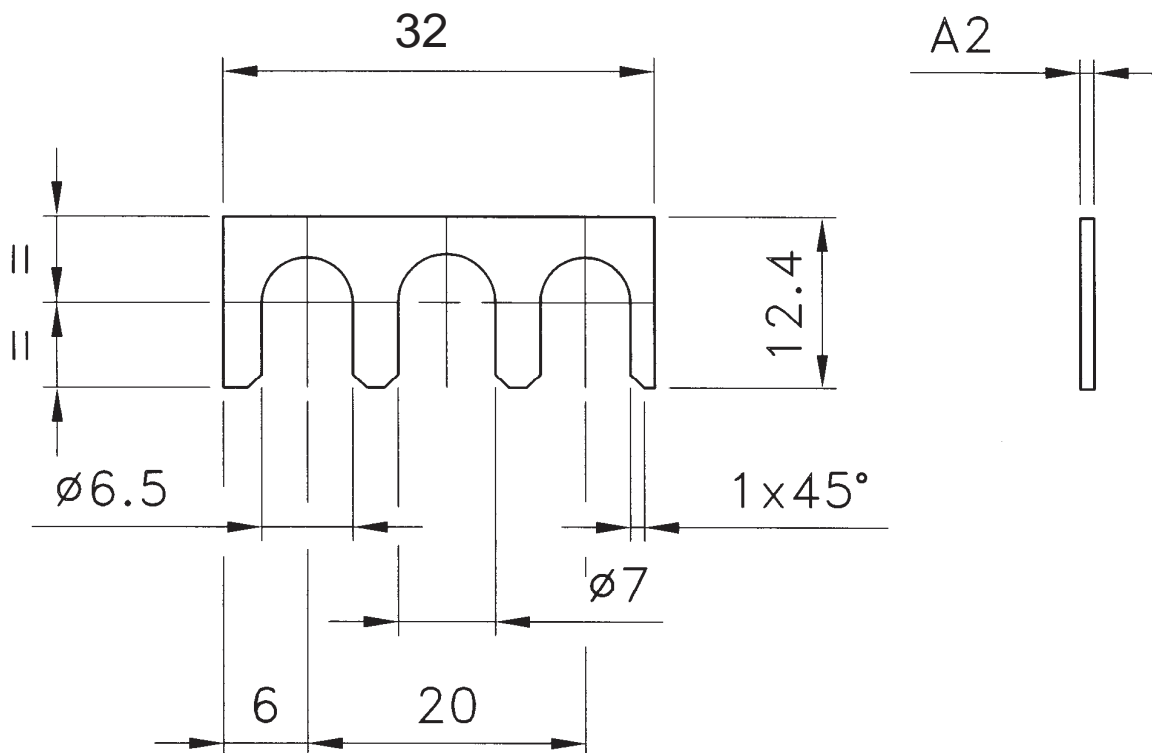

Ordering example:

Shims complete 236500

Shims complete: = Type
 236500 = Order number

Shims complete includes:

AP 4305 = 2 x
AP 4310 = 2 x
AP 4320 = 1 x

Shims Type	A2	Order-no.
AP 4305	0.5	218602
AP 4310	1.0	218603
AP 4320	2.0	218604

*Tolerance for dowel holes $\pm 0,02$, for screw holes $\pm 0,1$.

