

Retractable Locating Pin

for locating pins

SZK 30 B
20 stroke

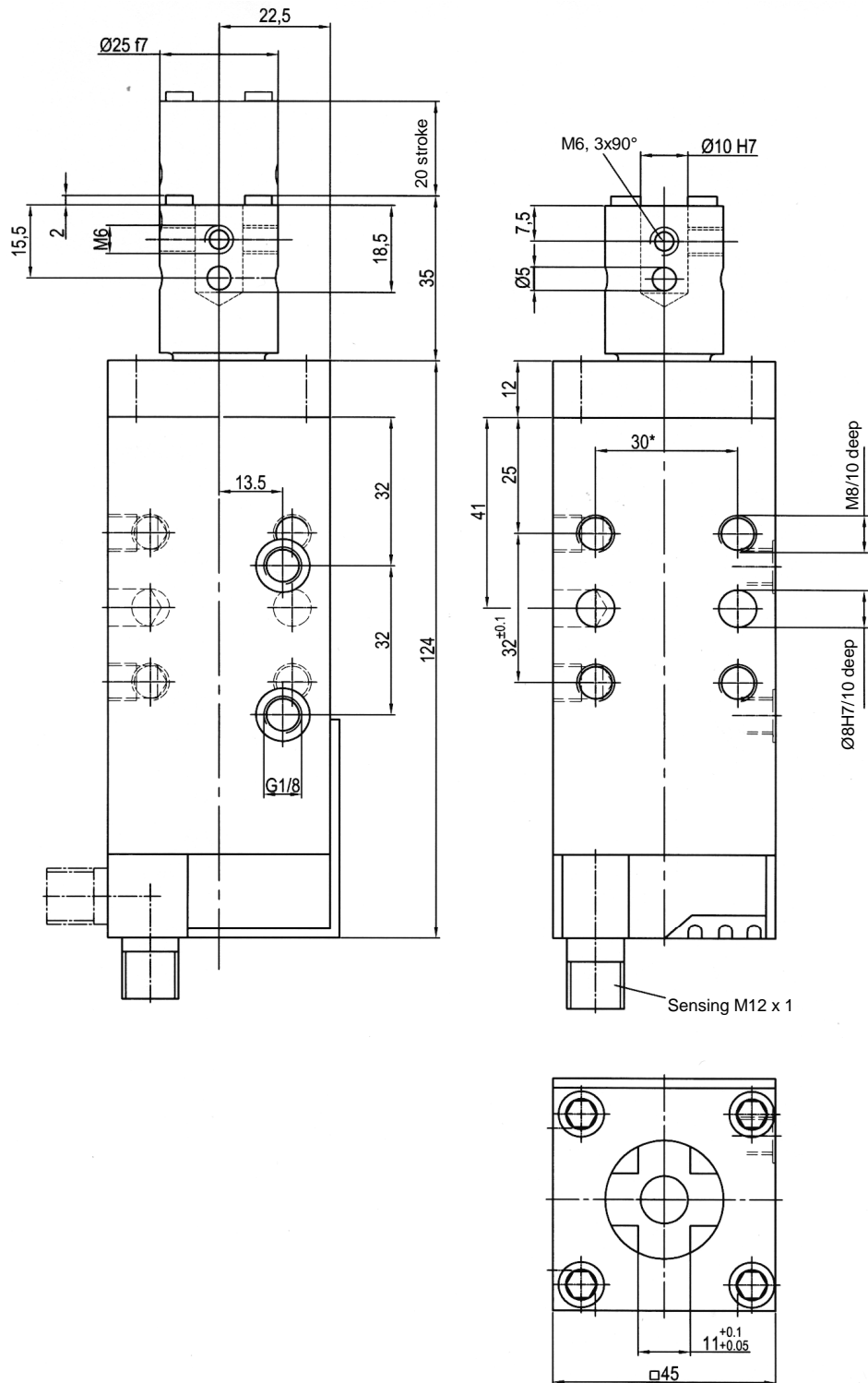

Ordering example:

SZK 30 B T12

SZK 30 B: Type
T12: Sensing system

Ordering example Tünkers sensing systems:

...T00 Without sensing
...T12 Inductive sensor 24 V, 1 output
with integrated LED's

Piston Ø 30

Tensile force: 250 N at 5 bar

Weight 0.8 kg

*Tolerance for dowel holes ± 0.02 , for threaded holes ± 0.1 .
Medium: Air, max. 6 bar, operation permitted with oil-free air.

Attention!

External throttle check valves must be provided on assembly. They are not included in the scope of delivery!