

Clamp arms

for Clamps size 80 with an offset of 45 mm
and with contour wheel insulation (A43, 44, 45)

A40, 41, 42

A43, 44, 45

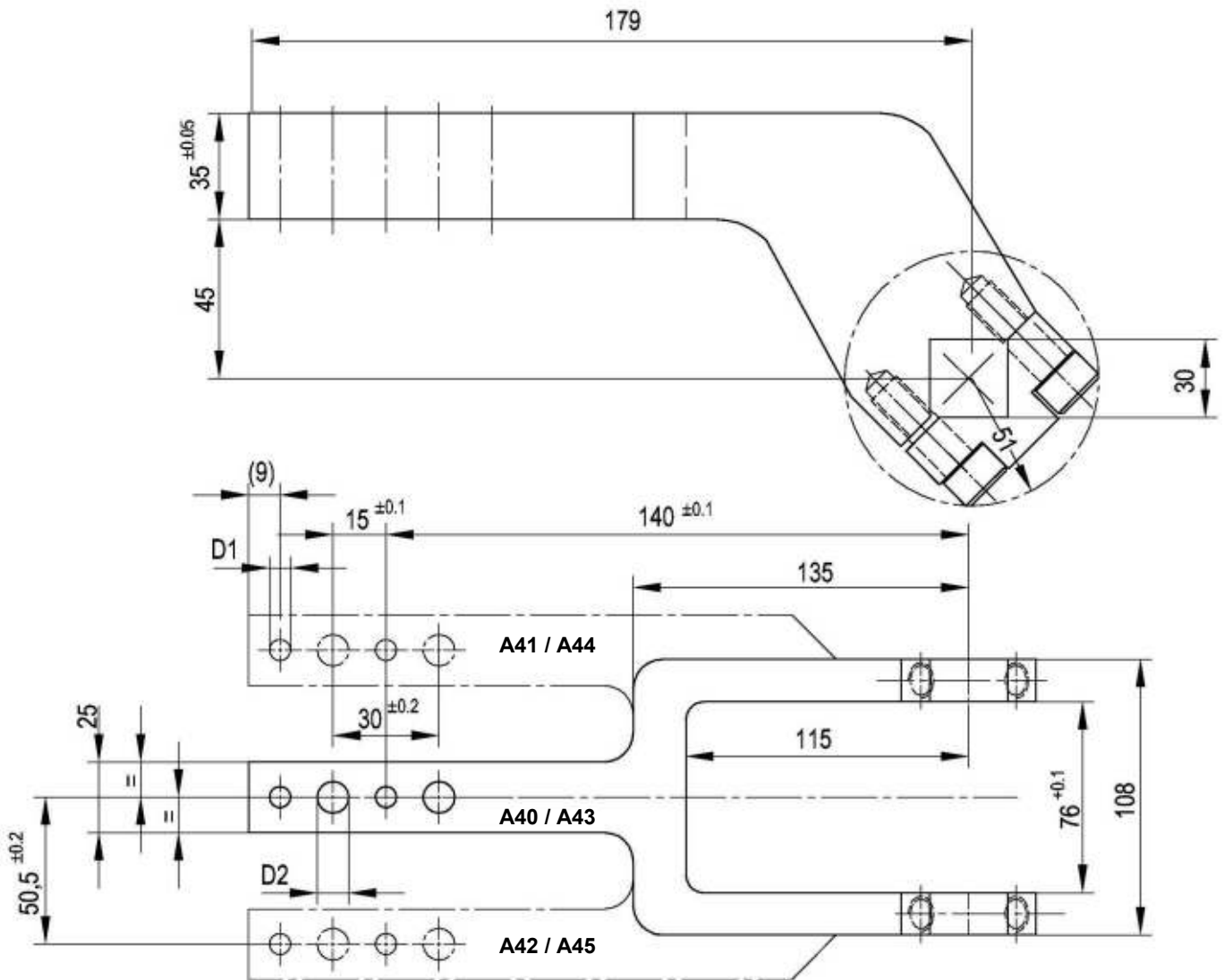

Ordering example clamp arm complete:

240279: Clamp arm complete A43

Ordering example for a complete clamp:

V 80.1 A43 T12

V 80.1: Type
A43: Clamp arm version
T12: Sensing system

Clamp size	Clamp arm version A40 order no.	Clamp arm version A41 order no.	Clamp arm version A42 order no.	Weight ~ (kg)	D1 _{H7}	D2
80	246238	248921	248923	2.5	6	9

Clamp size	Clamp arm version A43 order no.	Clamp arm version A44 order no.	Clamp arm version A45 order no.	D1 _{H7}	D2
80	240279	267357	267355	8	10.2